

S-SERIES

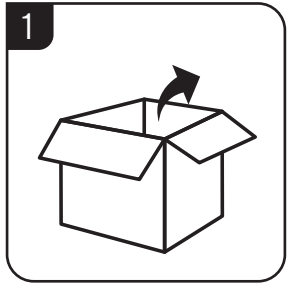

USER GUIDE

User Guide for S-Series Home Cinema



1
Unpack all contents including power supplies.

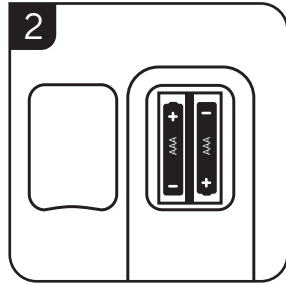

2
Insert batteries into Remote Control.

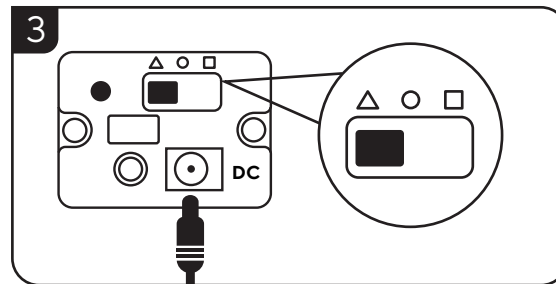

3
Select a location for the first S-Cube surround speaker, connect power cable. For left surround move switch on S-Cube to Triangle Δ . For right surround select square \square .

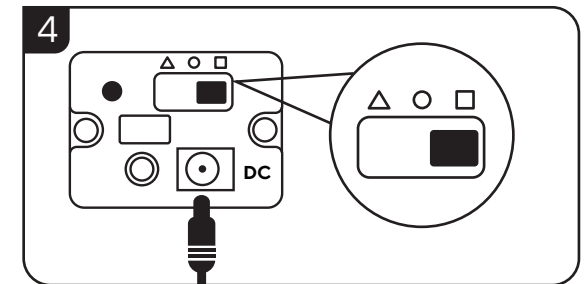

4
Select a location for the Second S-Cube surround speaker, connect power cable and position the switch to the appropriate icon for left or right surround.

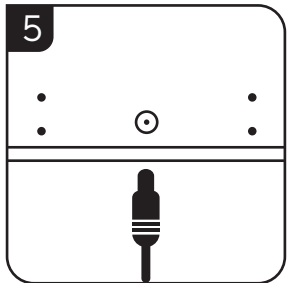

5
Position the Soundbar in front of the display (TV/Projector), connect power cable.

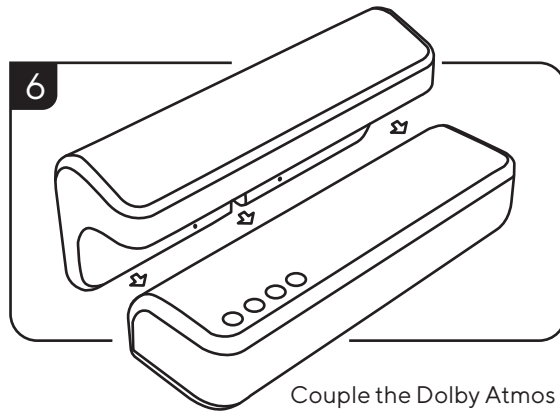

6
Couple the Dolby Atmos speaker onto the soundbar, it will snap into place.

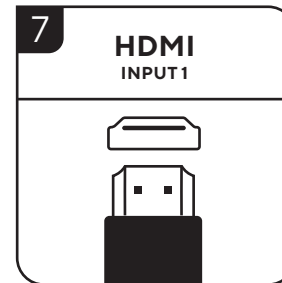

7
HDMI INPUT
Insert the HDMI source into the Subwoofer.

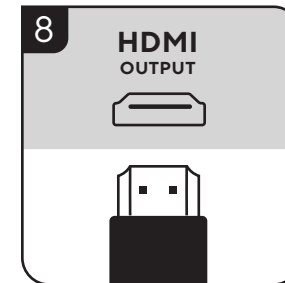

8
HDMI OUTPUT
Insert the HDMI output that will connect to the display.

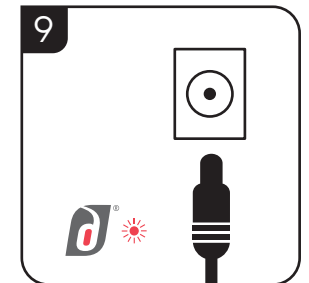

9
Connect the power supply to the sub-woofer. The Logo will turn red on the subwoofer.

10
The system will now power up and configure itself. The Subwoofer logo will turn red, the Soundbar logo will light up red and the S-Cubes logo will display light blue.

Please note: On initial set up it is recommended to connect the power supply of the subwoofer last as this provides auto-power upon initial setup. If the subwoofer is powered up before the other speakers are connected you will need to power off the subwoofer either by removing the power cable or pressing the power button on the remote control until the LED turns off, then power on again by remote control.

Please note: The S-Cubes are set up to power on automatically to the surround sound system only when connected to a power supply.

Dolby, Dolby Atmos, Dolby Audio, Pro Logic, and the double-D symbol are trademarks of Dolby Laboratories

Dolby® Atmos Wireless Home Cinema System

SPEAKER GUIDE

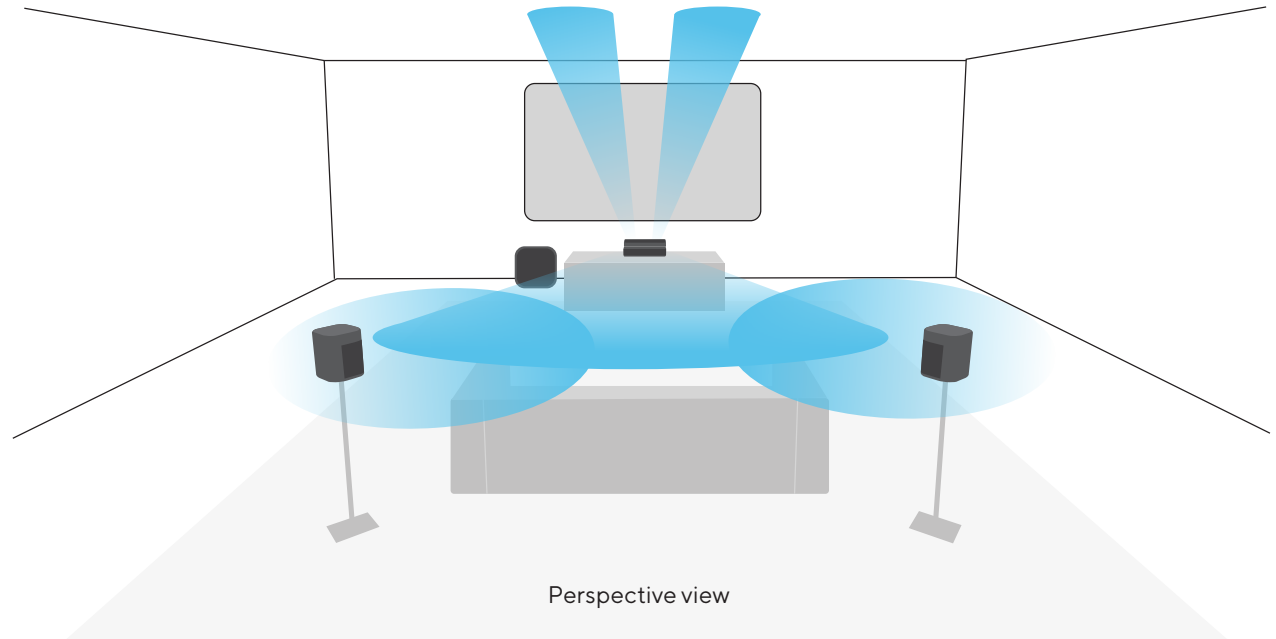
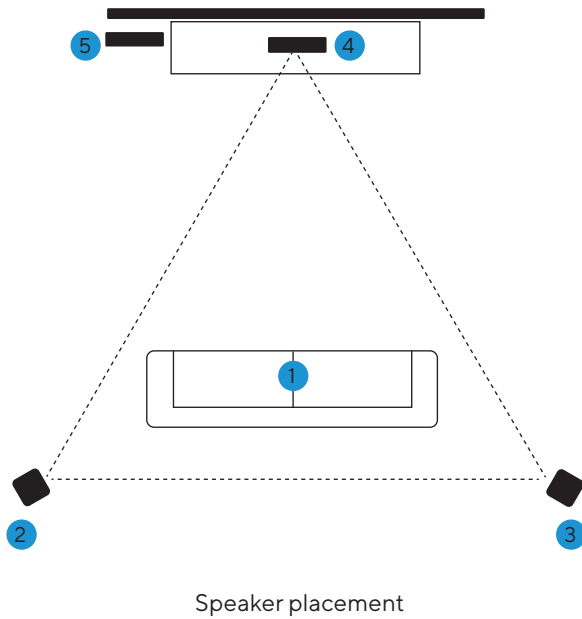

1. Seating position
2. S-cube left speaker
3. S-cube right speaker
4. S-Bar with Dolby Atmos extension
5. S-Woofer*

*S-Woofer LED will flash when it is receiving Dolby Atmos Content

Using your TV's ARC Function

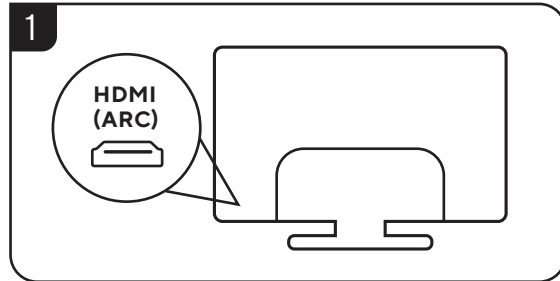

Ensure the TV has the ARC port

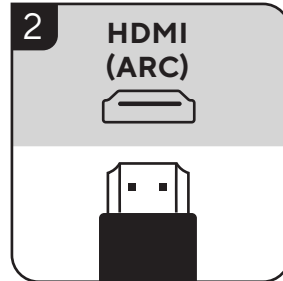

Plug the HDMI cable into the port HDMI(ARC) on TV

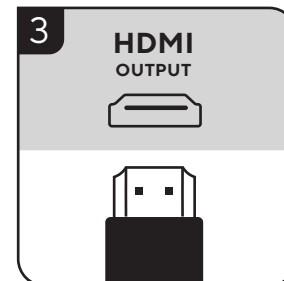

Insert the other end of the HDMI cable into S-Woofer HDMI Out port

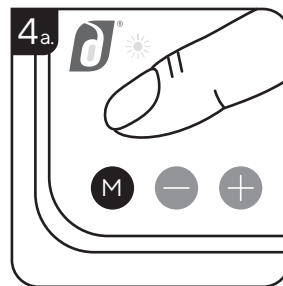
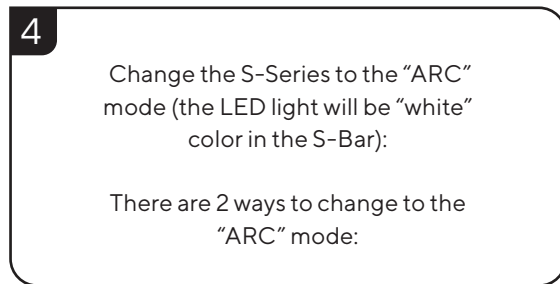

a. Press the "Mode" button "M" in the S-Bar quickly

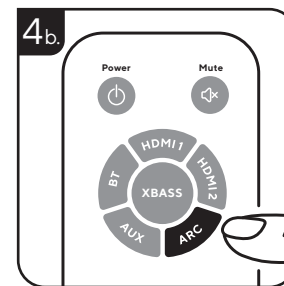

b. Press the "ARC" button in the Remote Controller

Remote control

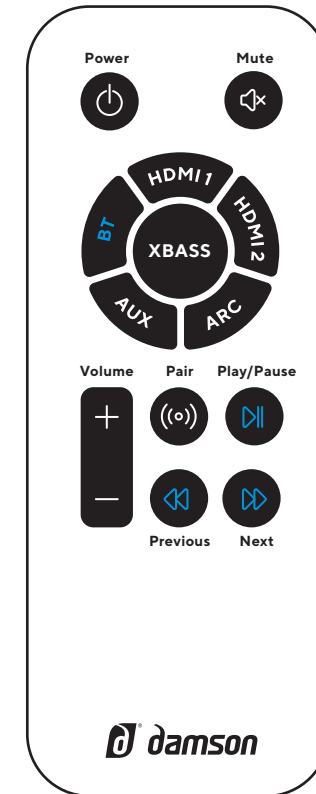

The LED colours on the soundbar when you press some of these buttons

- HDMI 1 Red
- HDMI 2 Indigo
- ARC White
- AUX Green
- BT Blue

When receiving Dolby Atmos audio the Subwoofer LED will flash, for all other content the LED remains constant.

Blue Buttons only work when in Bluetooth mode.

Pressing the X-Bass button will optimise the sound for music or tv viewing. When the Logo is Blue it is set for music. when it is red it is set for TV audio.

Using S-Series for Home Cinema

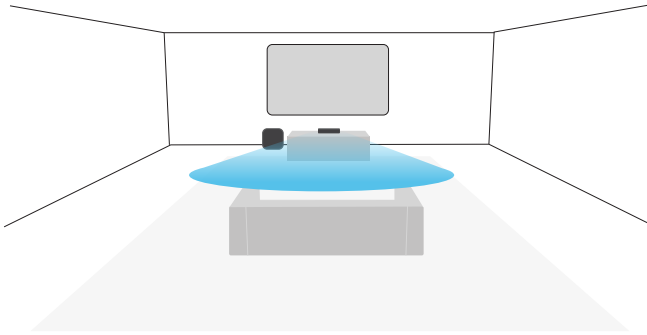

Soundbar and Subwoofer will deliver Dolby Virtual Surround sound

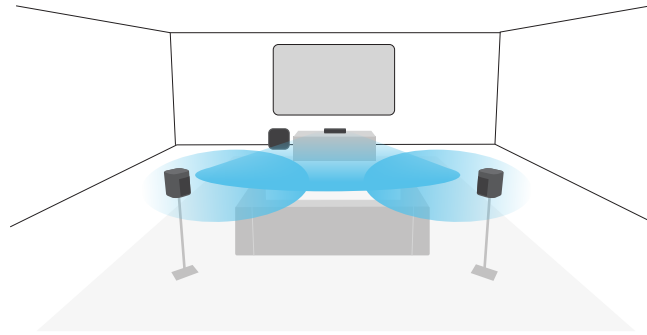

Soundbar and Subwoofer with 2 S-Cubes work as Dolby 5.1 surround supporting Dolby Digital+ and Dolby TrueHD

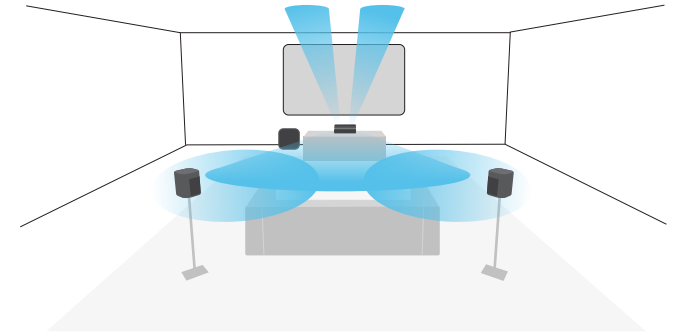

With the Atmos module added experience Full 3D surround sound through Dolby Atmos

Multi-Room Audio

The S-Cubes speakers can also be used as either standalone speakers or multi-room speakers using Damson JetStreamNet.

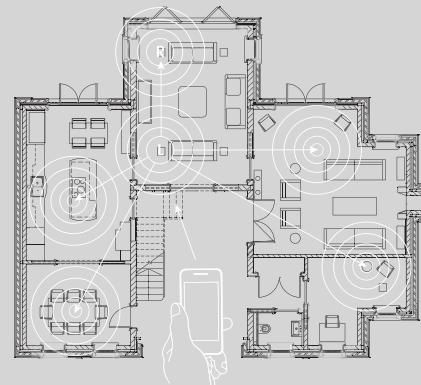

User Guide for S-Cube



Power/Mode (BT/Aux/JSN),
Vol -, Vol +, Play/Pause.

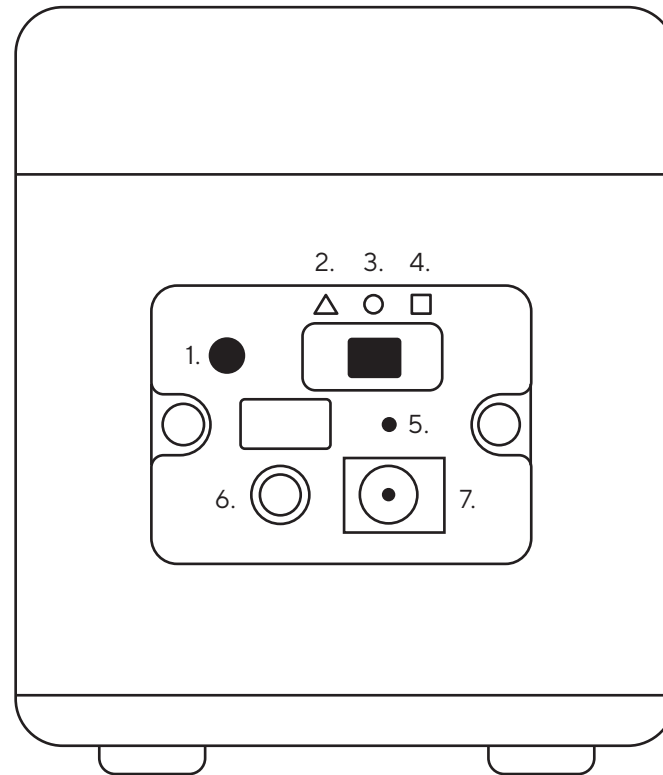

1. JetStreamNet Pairing,
2. Triangle, 3. Circle, 4. Square
5. Reset, 6. AUX In, 7. AC/DC Input

S-Cube has three primary functions:

1. Individual Stereo Speaker

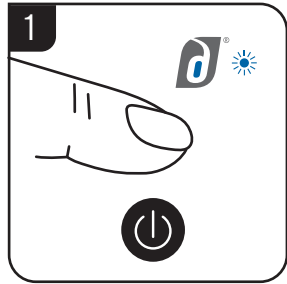

Power on and change mode to either BT (Blue LED) or

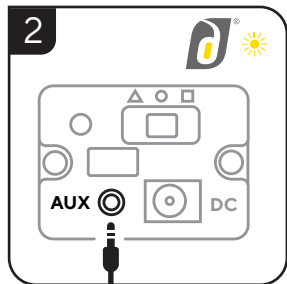

Insert a cable into the AUX port for wired connectoin. The LED will light up yellow.

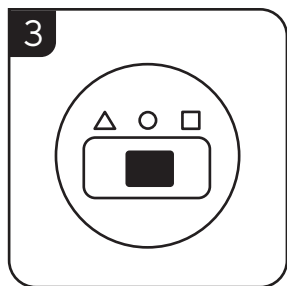

If selecting BT pair your device to Damson S-Cube. Function mode should be set to Circle

2. Multi Speaker

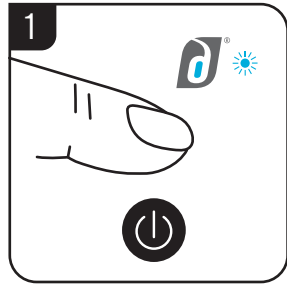

Select a primary speaker to connect to your device to S-Cube. Power on additional speakers and change function to JetStreamNet mode (light blue LED).

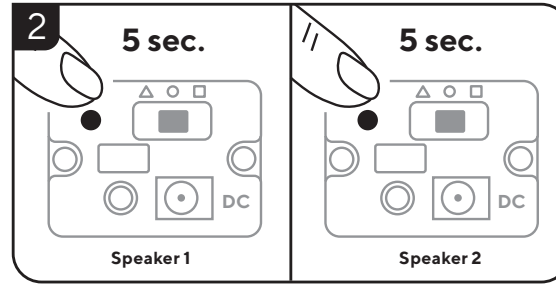

Bring the additional speakers close to the primary speaker and **press and hold the JSN Pairing button for 5 seconds on both speakers at the same time.** Speakers are now connected. Repeat for up to 8 speakers.

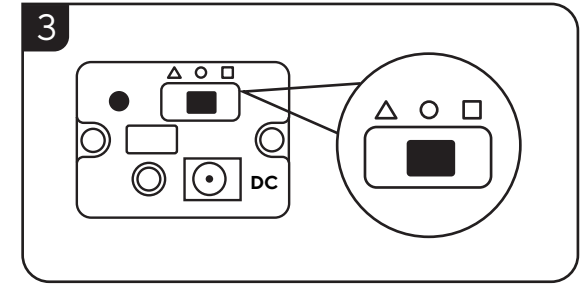

Change the output of each speaker. Select Triangle for Stereo left channel and Square for Stereo Right channel, or circle on each device if you wish to play stereo on each speaker.

3. S-Series Surround - Establishing a connection or reconnecting.

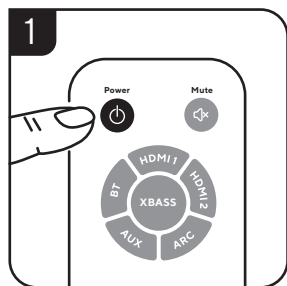

Power On the S-Woofer with remote control.

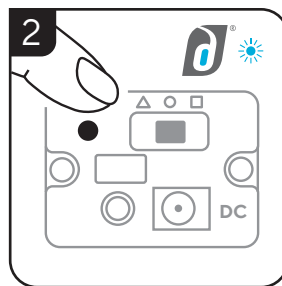

Change the mode on the S-Cubes to JetStreamNet (light blue).

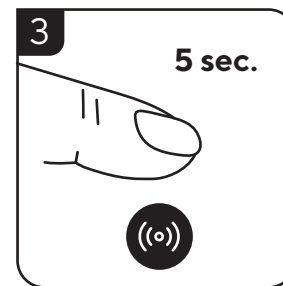

On the remote control press and hold the Wireless button for 5 seconds. Pairing will complete.

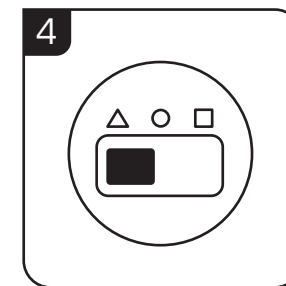

On the left surround speaker change the output switch to \triangle triangle.

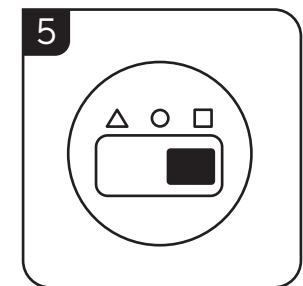

On the right surround speaker change the output switch to \square square.